

- Notes:**
- This drawing is to be read in conjunction with relevant drawings, specification and reports.
 - Dimensions are in metres, unless noted otherwise.
 - Do not scale from this Drawing.
 - Survey carried out by SLR Consulting Ltd between the 8th - 13th February 2025.
 - Survey carried out using UAV with LIDAR.
 - The proposed turbine layout should be used for planning purposes only.
 - The final turbine handstanding is subject to finalisation of a candidate turbine.
 - Mapping extract from Ordnance Survey, Map Series 6 inch Reader: Map Sheets MO016, MO025, MO026, MO027 and MO028; Map Series 1:2,500 Map Sheets 1238-C and MO029; Map Series 1:5,000 Map Sheets 1238, 1305 and 1310.
 - Co-ordinate system - Assigned REIN2025 Irish TM.
- Legend:**
- Planning Application Boundary
 - Area under Applicant control
 - Watercourse/Features
 - Existing Ground Contours (2m Intervals)
 - Right of Way
 - Over-run Area to facilitate delivery of windfarm components (OA-1, 2, 3)

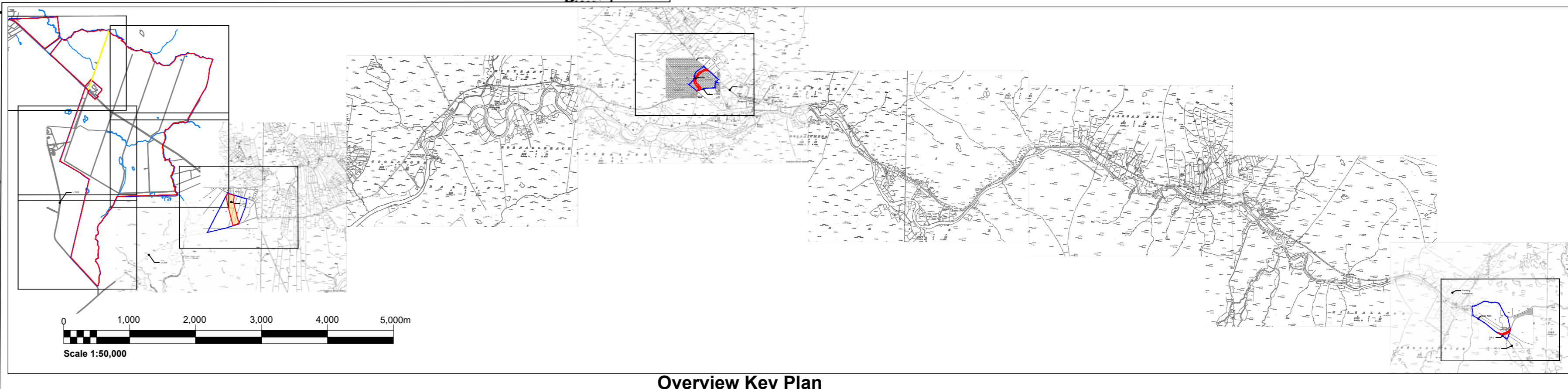
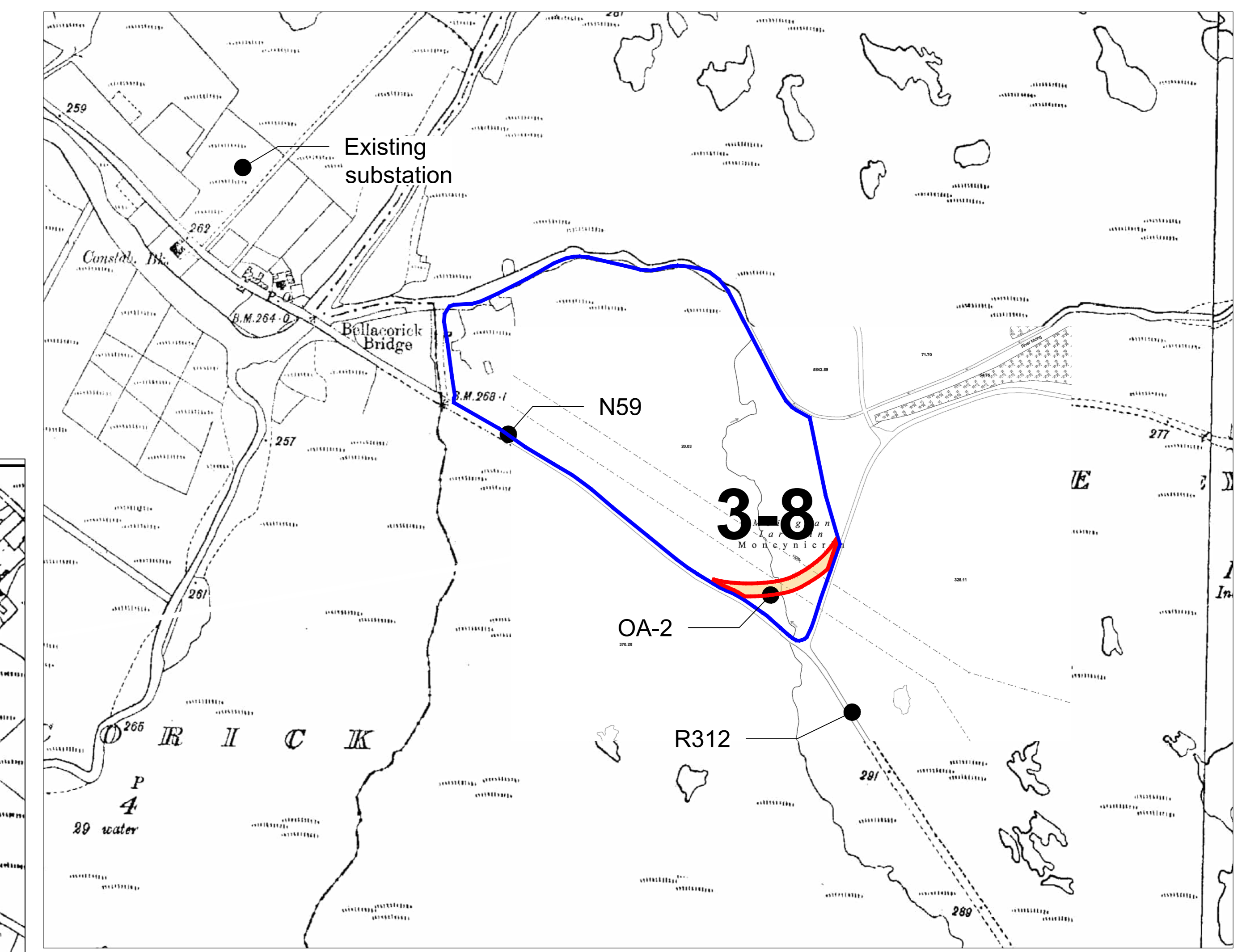
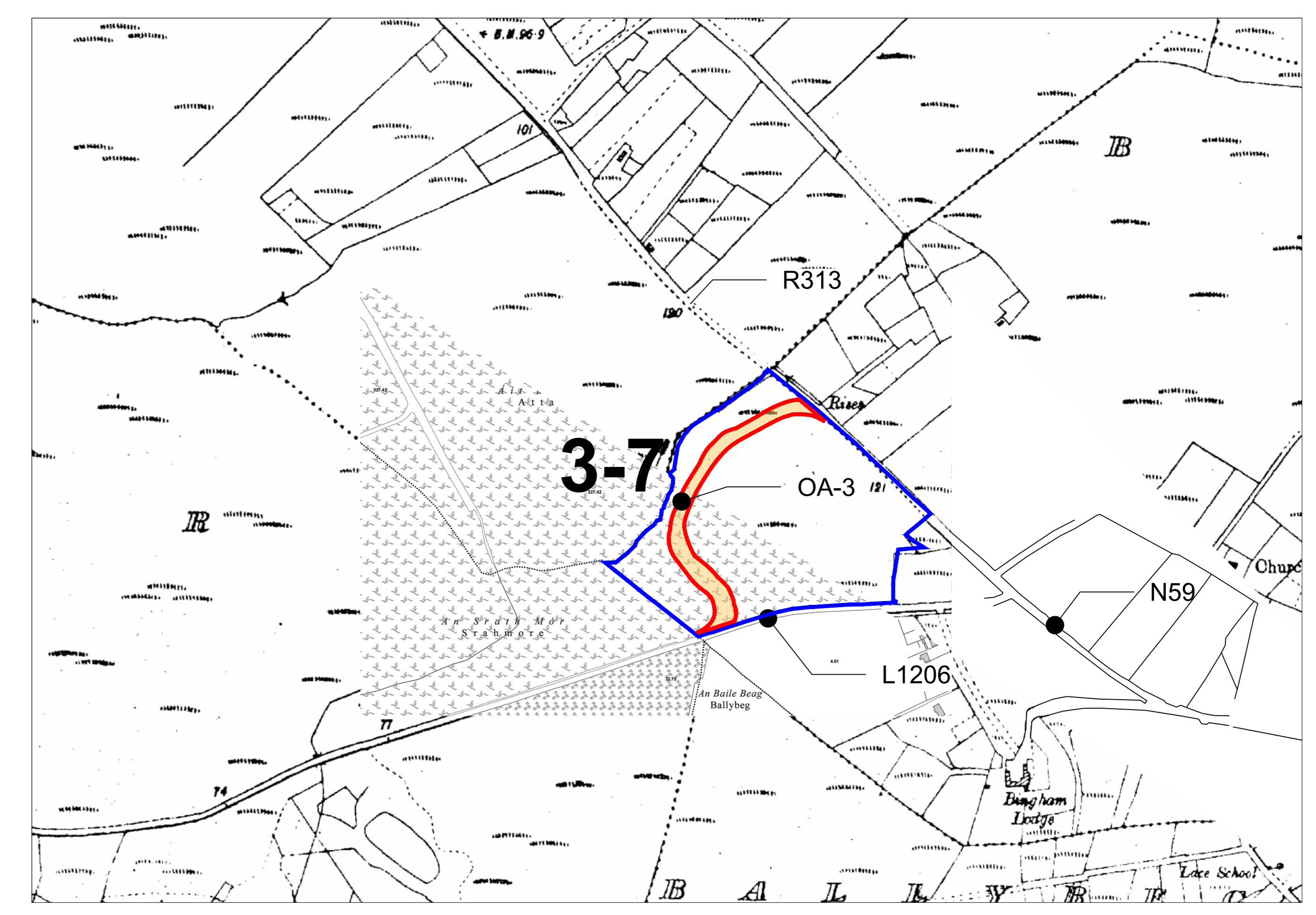
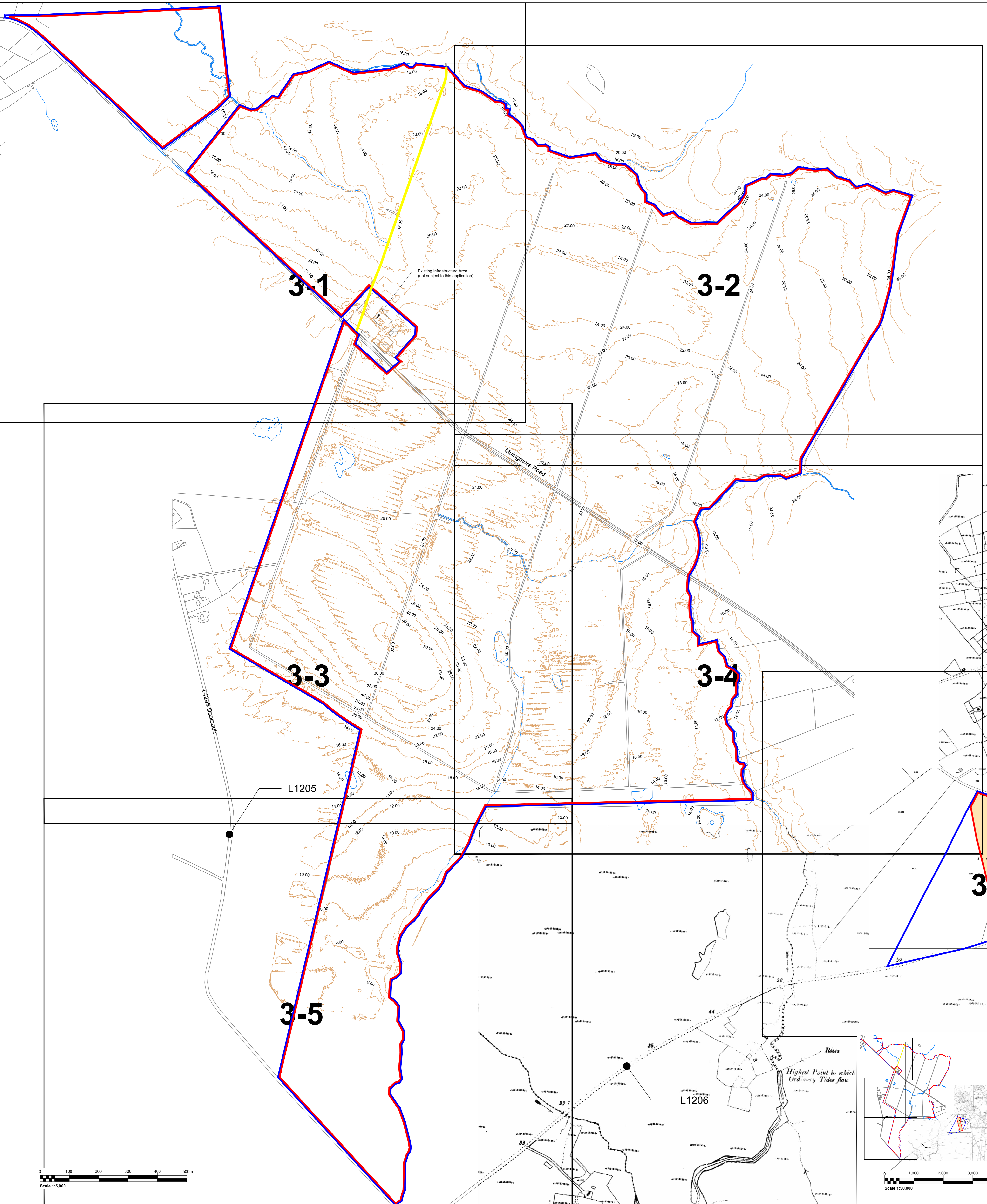

P02	Client's comments	04/26	SLR	RA	GH
P01	Initial Issue	12/25	IG	RA	GH
Rev	Amendments	Date	By	CHK	Auth
			SLR Consulting Ireland		
			7 Dunraven Business Park, Wexford, Ireland, D24 N6Y7		
SLR					
www.slrconsulting.com					
Client: RWE Renewables Ireland					
Project: Muingmore Wind Farm					
Drawing Title: Existing Site Layout - Key Plan					
Scale:	1:5,000	@ A0	501.065301.00001		
Designer:	IG	Checker:	DR		
Date:	12/25	Date:	04/26		
Author:	D03	Checker:	P02		