

- Notes:**
1. This drawing is to be read in conjunction with relevant drawings, specification and reports.
 2. Dimensions are in metres, unless noted otherwise.
 3. Do not scale from this Drawing.
 4. Survey carried out by SLR Consulting Ltd between the 8th - 13th February 2025.
 5. Survey carried out using UAV with LIDAR.
 6. The proposed turbine layout should be used for planning purposes only.
 7. The final turbine hardstanding is subject to finalisation of a candidate turbine.
 8. Mapping extract from Ordnance Survey, Map Series 6 Inch Raster, Map Sheets M0018, M0025, M0026, M0027 and M0028; Map Series 1:2,500 Map Sheets 1238-C; Map Series 1:5,000 Map Sheets 1238, 1305 and 1310.
 9. Co-ordinate system - Assigned IRENE95 Irish TM.

- Legend:**
- Planning Application Boundary
 - Area under Applicant control
 - Watercourse/Features
 - 20.00 Existing Ground Contours (2m Intervals)
 - Proposed Hardstanding / Areas Cleared and Levelled
 - Proposed BESS Compound
 - Proposed Substation
 - Proposed Temporary Construction Compound
 - Proposed Met Mast Location
 - Proposed Areas of Cut
 - Proposed Areas of Fill
 - Internal Access Track
 - Proposed Turbine
 - Tree Felling Area
 - Turbine Delivery Route
 - Right of Way
 - Collector Cables
 - Proposed Grid Connection Route (Subject to a separate planning application)

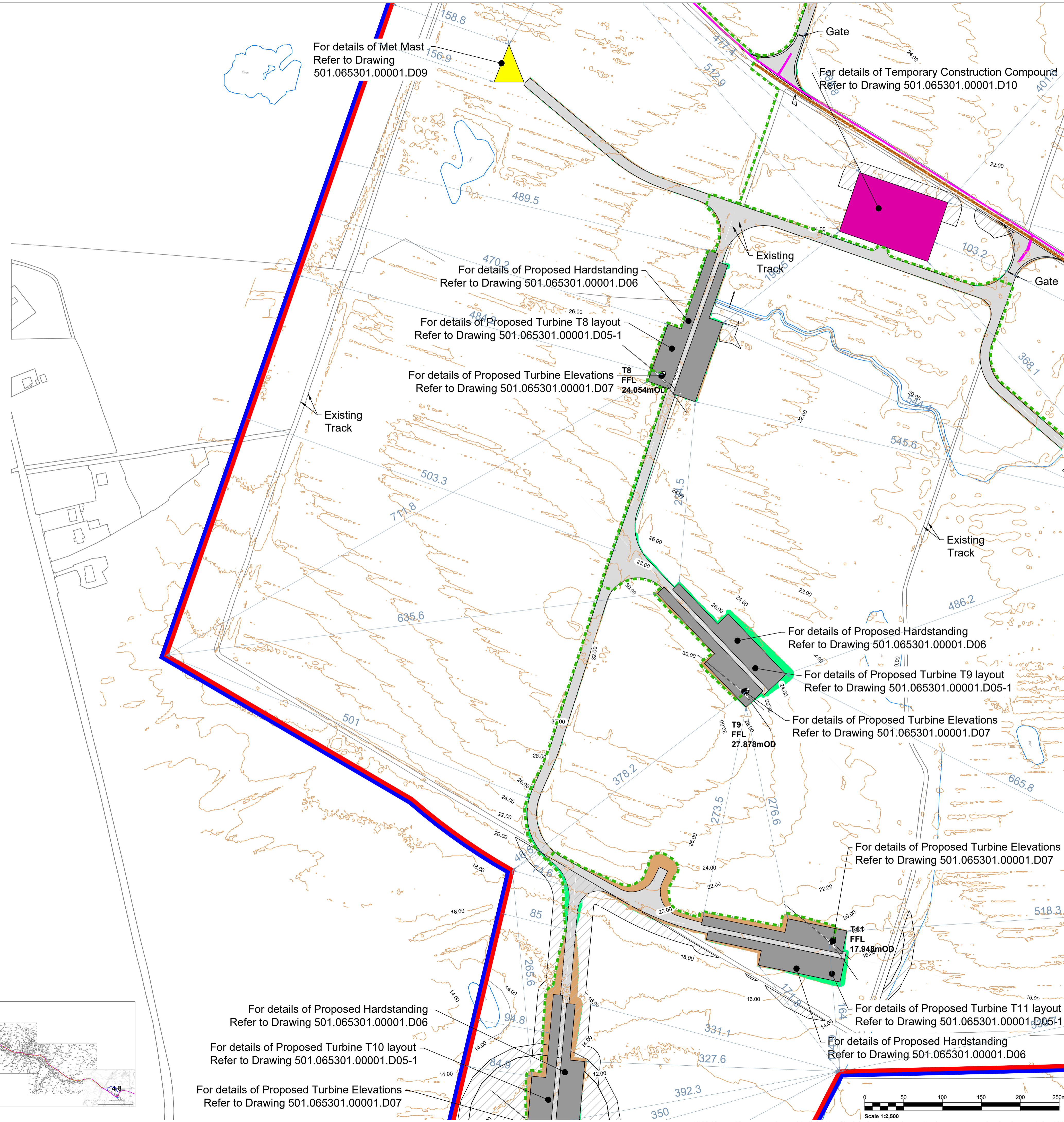

P02	Clients comments	04/26	SJB	RA	GH
P01	Initial Issue	12/25	IG	RA	GH
Rev	Amendments	Date	By	Chk	Auth

SLR SLR Consulting Ireland
7 Dundrum Business Park, Windy Arbour, Dublin, Ireland. D14 N2V7

www.slrconsulting.com

Client: RWE Renewables Ireland

Project: Muingmore Wind Farm

Figure Title: Proposed Site Layout - Sheet 3 of 8

Scale: 1:2,500 @ A1	SLR Project No: 501.065301.00001		
Designed: IG	Drawn: IG	Checked: DR	Authorised: GH
Date: 12/25	Date: 12/25	Date: 04/26	Date: 04/26
Figure Number: D04-3	Rev: P02		

