

- Notes:
- This drawing is to be read in conjunction with relevant drawings, specification and reports.
 - Dimensions are in metres, unless stated otherwise.
 - Do not scale from this Drawing.
 - Survey carried out by SLR Consulting Ltd between the 8th - 13th February 2025.
 - Survey carried out using UAV with LIDAR.
 - The proposed turbine layout should be used for planning purposes only.
 - The final turbine hardstanding is subject to finalisation of a candidate turbine.
 - Mapping extract from Ordnance Survey, Map Series 6 10m Rescale, Map Sheets M0018, M0025, M0026, M0027 and M0028, Map Series 1:2500 Map Sheets 1238-C, Map Series 1:5000 Map Sheets 1238, 1305 and 1310.
 - Co-ordinate system - Assigned REIN20 Irish TM.

- Legend:
- Planning Application Boundary
 - Area under Applicant control
 - Watercourse/features
 - 20.00 Existing Ground Contours (2m Intervals)
 - Proposed Hardstanding / Areas Cleared and Levelled
 - Proposed BESS Compound
 - Proposed Substation
 - Proposed Temporary Construction Compound
 - Proposed Met Mast Location
 - Proposed Areas of Cut
 - Proposed Areas of Fill
 - Internal Access Track
 - Proposed Turbine
 - Turbine Delivery Route
 - Right of Way
 - Over-run Area to facilitate delivery of windfarm components (OA-1, 2, 3)
 - OA Track
 - Tree Felling Area
 - Collector Cables
 - Proposed Grid Connection Route (Subject to a separate planning application)

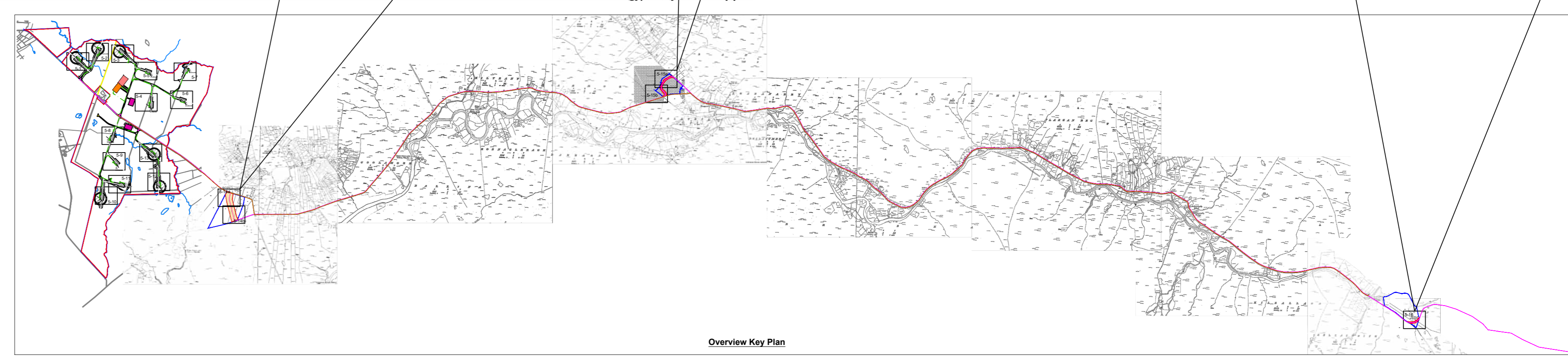
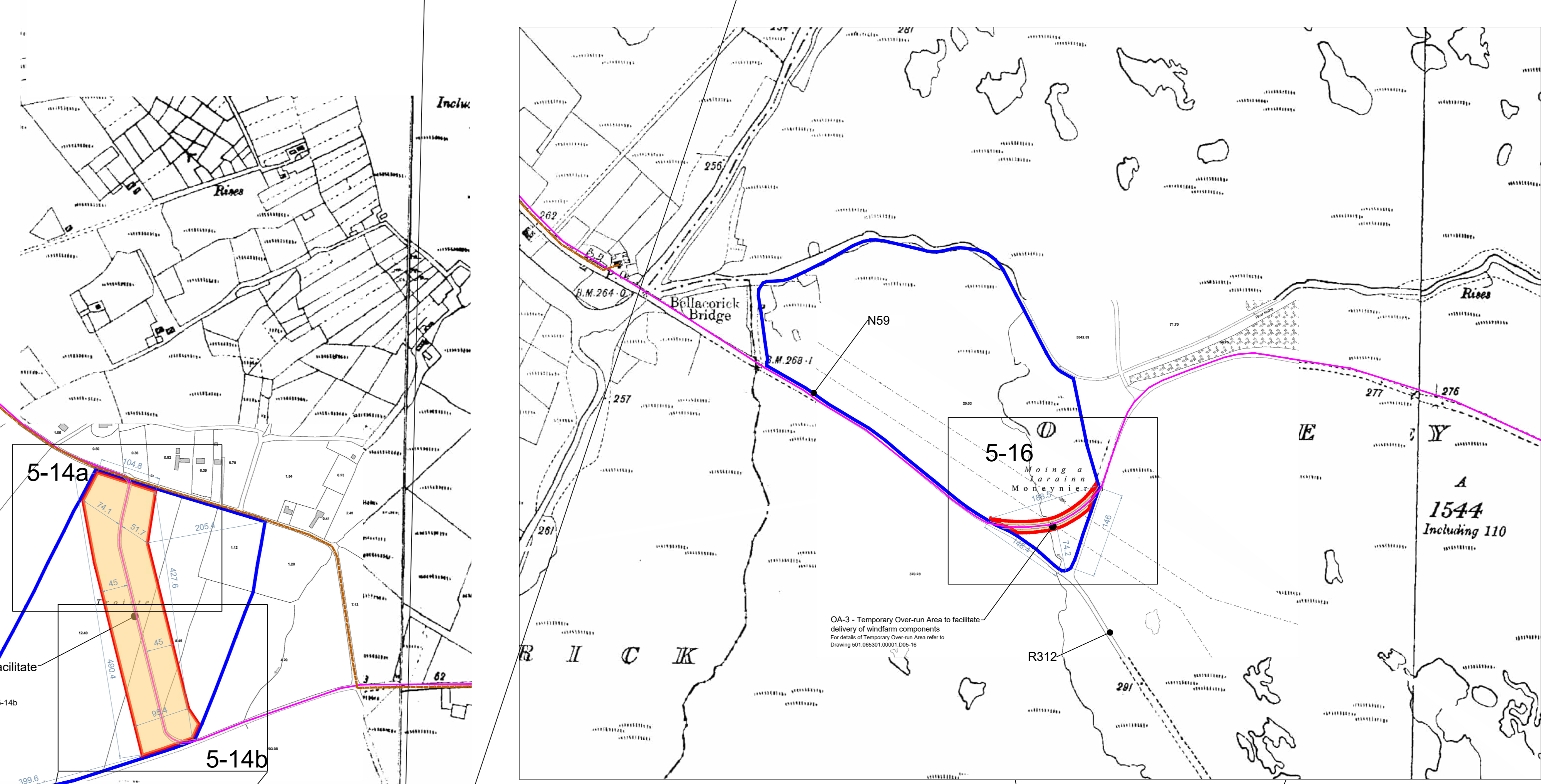
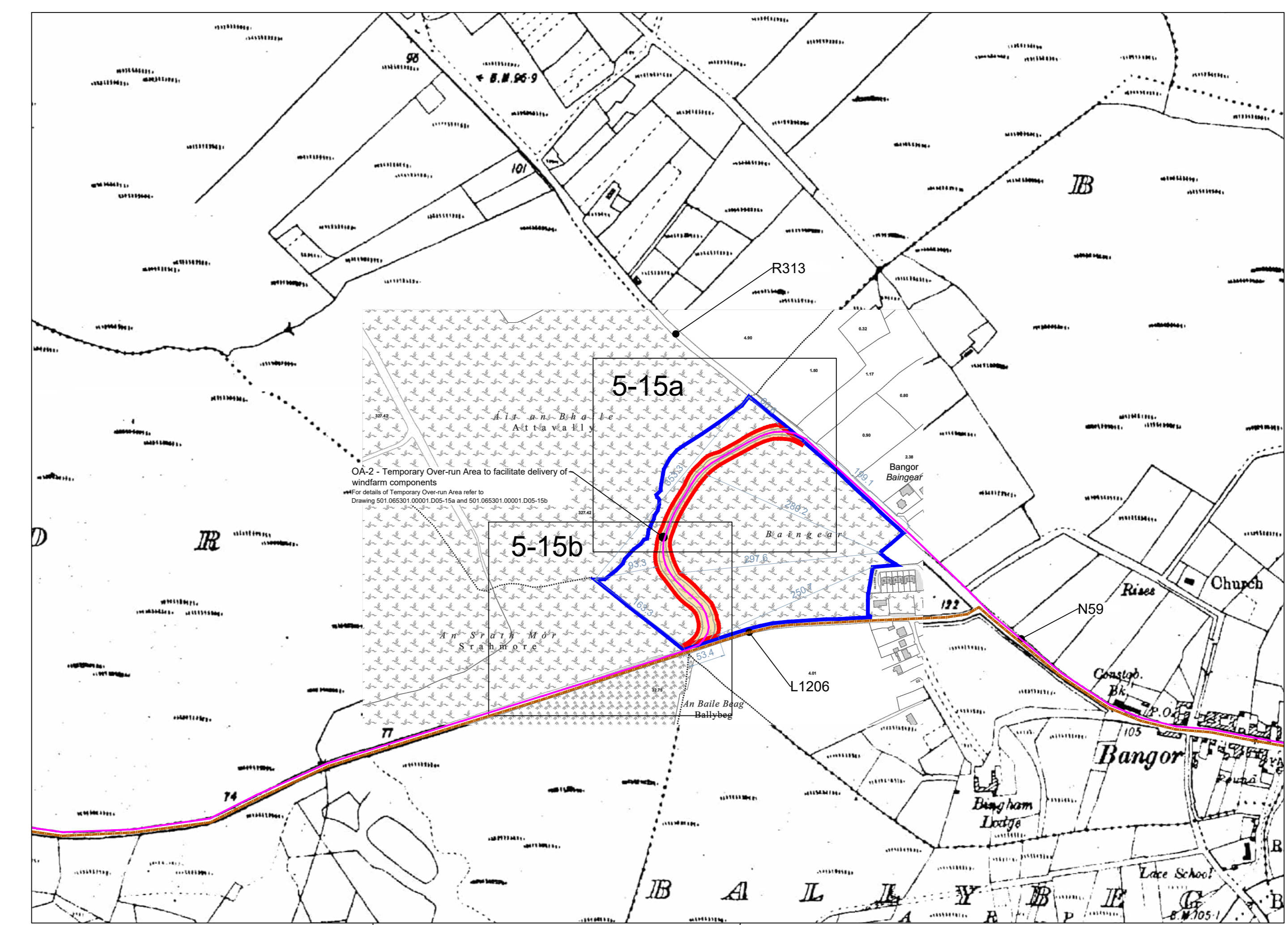
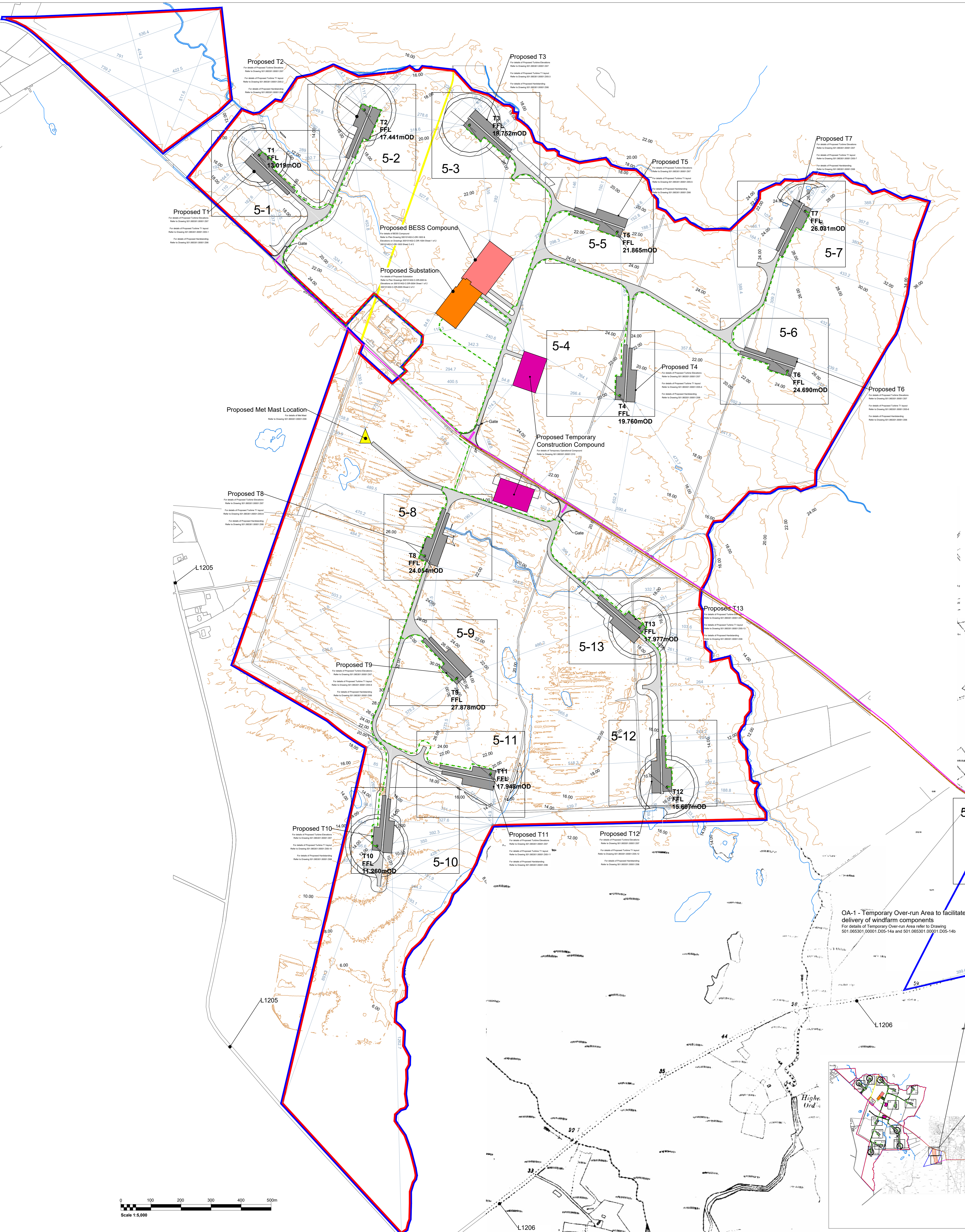

P02	Client's comments	04/26	SUB	RA	GH
P01	Initial Issue	12/25	IG	RA	GH
Rev	Amendments	Date	By	CHK	Auth

SLR Consulting Ireland
 7 Dunraven Business Park
 10000, Dunraven, Co. Wick, Ireland
 D14 N9Y7

www.slrconsulting.com

Client: RWE Renewables Ireland
 Project: Muingmore Wind Farm

Page Title: Proposed Turbine & Overrun Areas - Key Plan

Scale:	1:5,000	@ A0	SLR Project No:	501.065301.00001	
Designer:	IG	DR	Checker:	GH	
Date:	12/25	Date:	04/26	Date:	04/26
Drawn by:	D05	Checked by:	P02		